

Installation Instructions

Lexus NX / NXh (2015-2021)

Kit Contents



Metal mounting
brackets (3)

Screws (6)



Push-type
retainers (6)

Pins (6)



Clip bodies (6)

Anti-abrasion pads (9)



Push-type retainers (6)

Bumpons (5)



Hood protector blade (1)



Installation Procedure

NOTE: Vehicle surface temperature should be a minimum 15 degrees Celsius.

1. Be sure that the hood is clean and dry inside and out.

2. Install the five (5) bumpons as shown. **Attention: Bumpons must be installed on the hood, not on the deflector!!!**

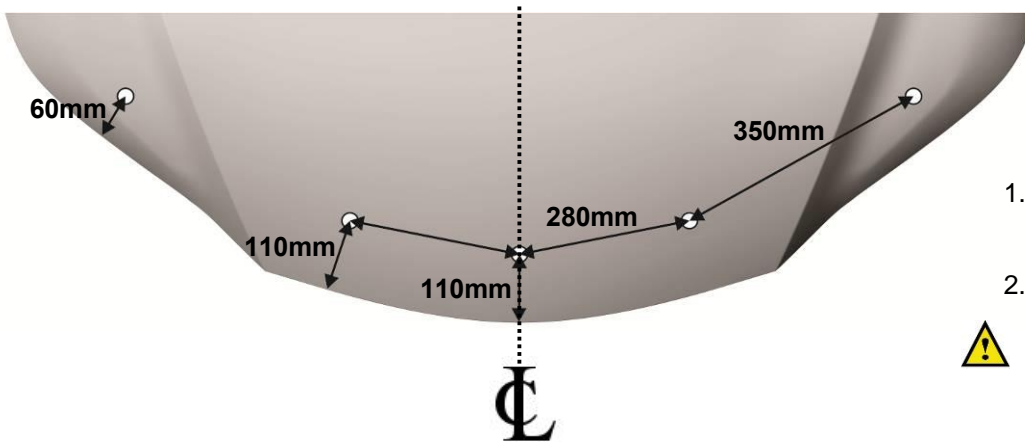

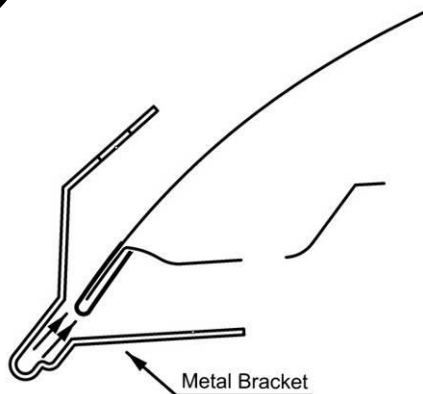
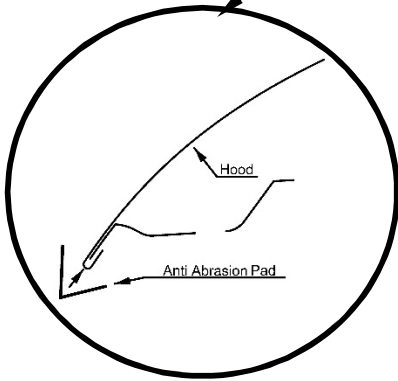

3. Open the hood of the vehicle. Peel and fold the anti-abrasion pads in half over the edge of the hood, in line with the 3(three) holes under the hood, as shown. *See illustration.*



4. Install the three metal brackets on the hood edge over the anti-abrasion pads. Align the hole in the bottom leg of the bracket with the round hole in the hood. *See Illustration.*

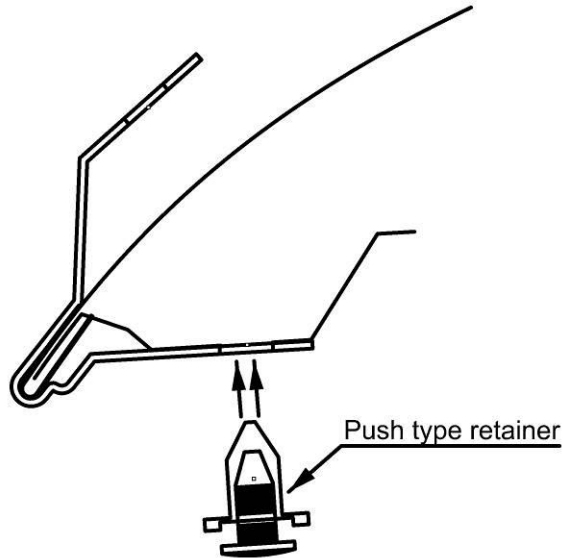



5. Insert a push-type retainer through the metal bracket and into the hood.  Ensure leg of the bracket is well seated against the surface of the hood and push the center pin of the retainer assembly to lock it into place. See *Illustration*.

NOTE: Engaging the center pin of the push-type retainer is best accomplished by placing a #2 Philips drive screwdriver into the recess of the center pin. Push on the screwdriver to seat the pin into the retainer. The retainer can be removed by unthreading the center pin with a Philips screwdriver, however initial installation is best done using the push method described above.

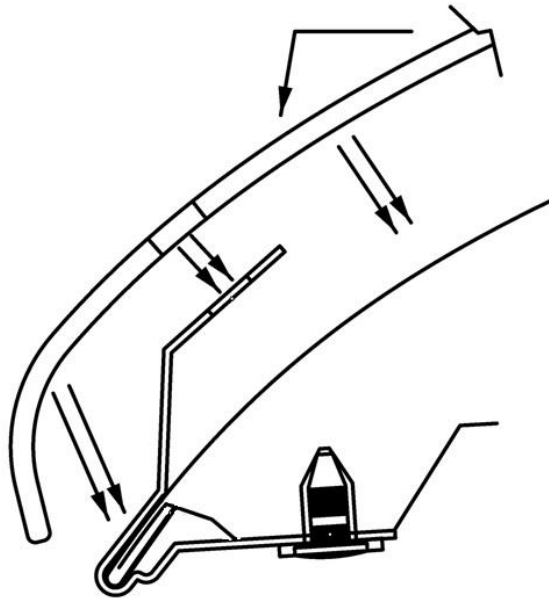

6. Place the hood protector on the hood, resting on the three metal brackets.

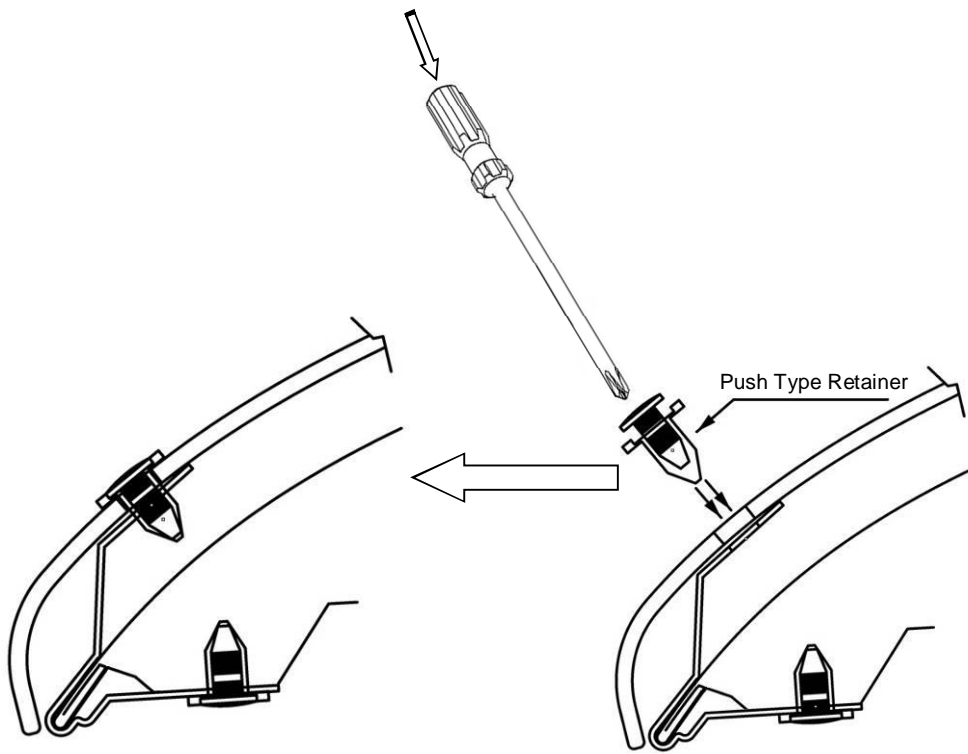

7. Align the 3 centre holes in the protector with the holes in the metal brackets.

- Insert a push-type retainer through the hole in a protector, and into the bracket below.
- Ensure the protector is seated against the metal bracket and push the centre pin of the retainer assembly to lock it into place. Repeat for the remaining push-type retainers.

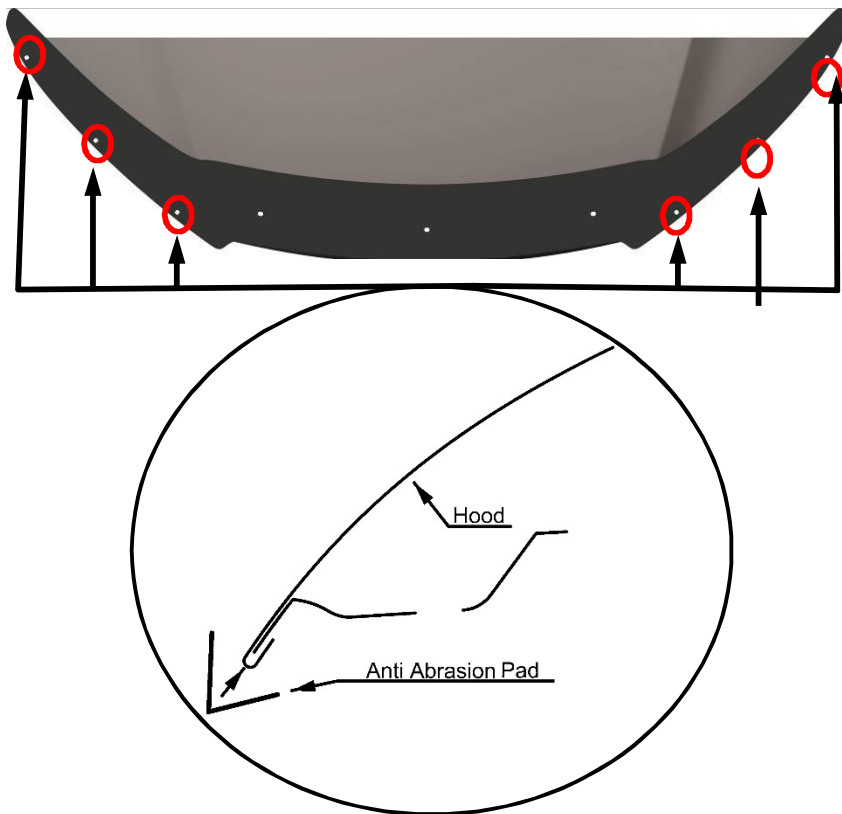

8. Peel and fold the anti-abrasion pads in half over the edge of the hood in line with the three holes in the protector over each of the headlights. *See Illustration.* Repeat for remaining push-type retainers.

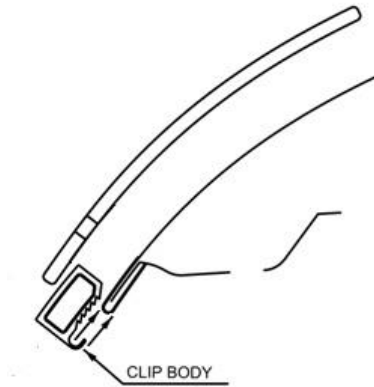

9. Place a clip body over one of the anti-abrasion pads on the edge of the hood.

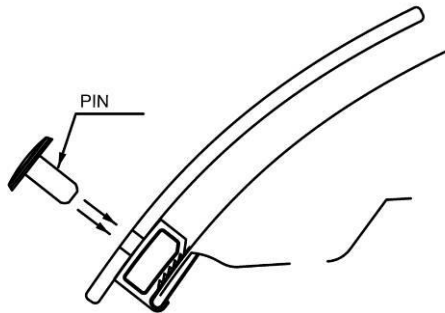

10. Insert a pin through the protector and into the clip.

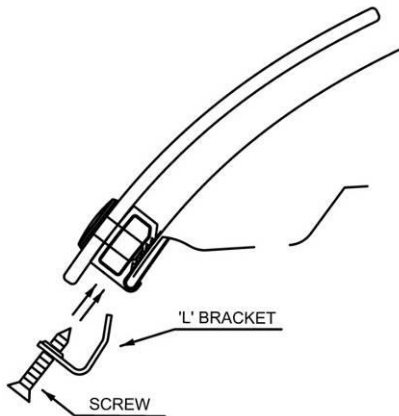

11. Start a screw through an L bracket and into the clip a few turns.

12. Repeat steps 9-11 to the remaining 5 clip assemblies.

13. Make sure all the components are well seated together; the protector is centered on the hood, and, starting at the innermost clip locations, finish tightening the screws into the clips. *Do not overtighten.*

CARE INSTRUCTIONS

Clean the protector with a mild soap and water solution or plastic cleaner only. Do not use chemicals or solvents. Periodically check to make sure the bumpons are in place and the protector is secure. Do not pull on the protector when opening or closing the hood.

