

Hardware Kit Contents:

1

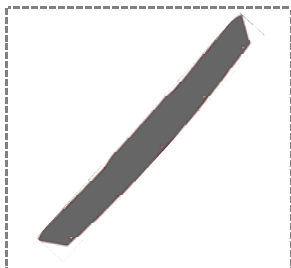

2

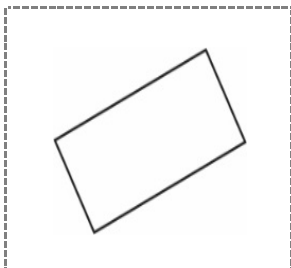

3

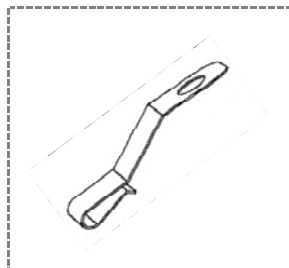

4

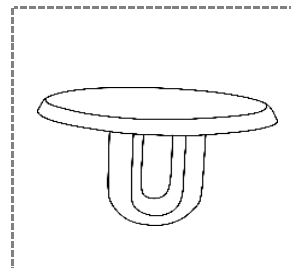

5

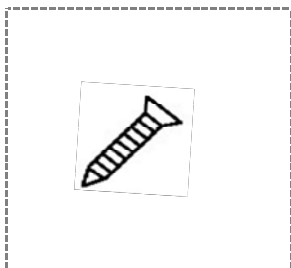

6

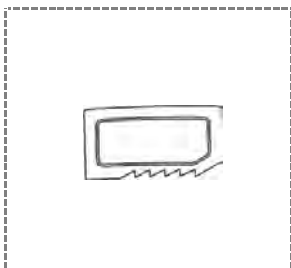

7

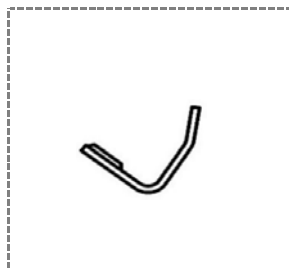

8

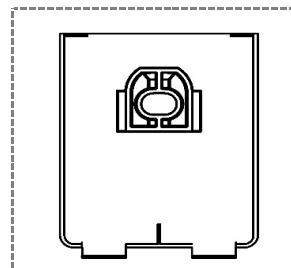

9



10



11

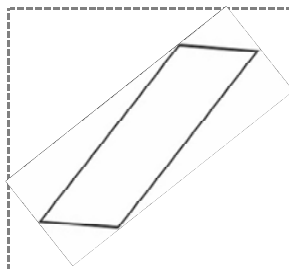

12

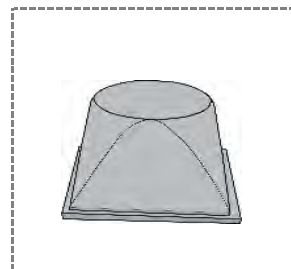

13

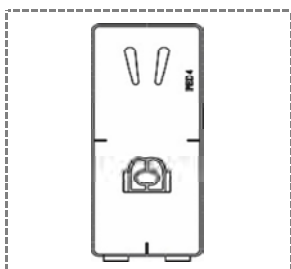
**Tools Required:**

- #2 Long Shank Phillips Screwdriver
- Clean cloth or paper towel

#	Qty.	Description	#	Qty.	Description
1	1	Hood protector	8	2	Small Adhesive pedestal
2	3	Anti-abrasion film pads - large	9	1	Surface Cleaner
3	6	Large Metal mounting brackets	10	1	Re-useable tape strips
4	8	Pins	11	6	Anti-abrasion film pads - small
5	8	Screws	12	4	Square Black Bumpons
6	2	Clip Bodies	13	4	Large Adhesive pedestals
7	2	Metal "L" brackets	14		

-Ensure the vehicle is clean and completely dry before installation. This product uses a 3M adhesive that requires installation and curing temperatures of 15° to 43°C (60° to 110°F) for 1 hr to develop maximum adhesion to the hood surface. Failure to install this product at the proper temperature or allow adequate curing time before use is not covered under warranty.

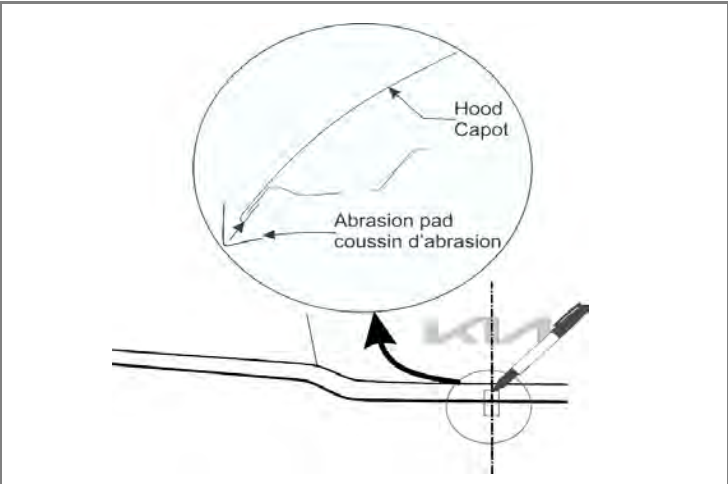

	Mark hood center	1
NOTE	Use the centre of the "I" in the Kia logo to establish centre. Place an anti-abrasion pad at centre and mark it with a sharpie or wax pencil.	

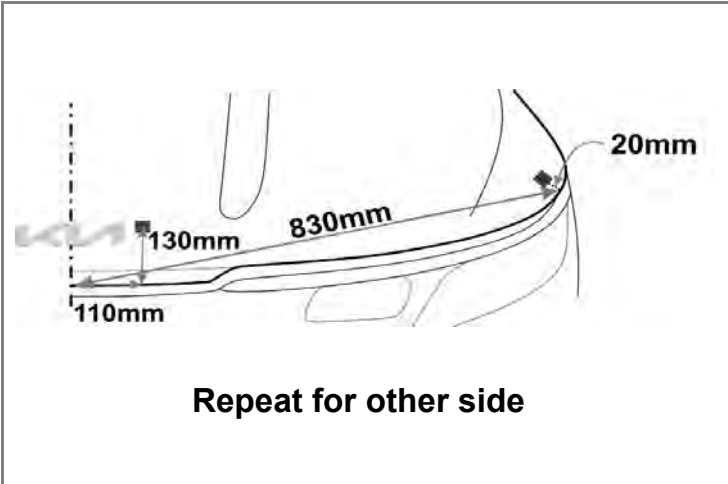

	Install bumpers	2
NOTE	Using the dimensions in the illustration, peel the protective backing from the bumpers and place them in position on the hood.	
	Bumpers must be installed on hood. If they are installed on the hood protector they may wear through the paint on the hood.	

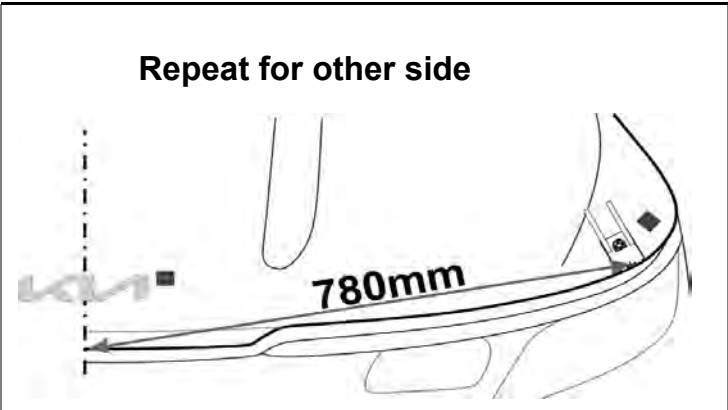

	Temporarily position outer pedestals	3
NOTE	Using the repositionable tape strips, temporarily place a mounting pedestal in the position illustrated.	

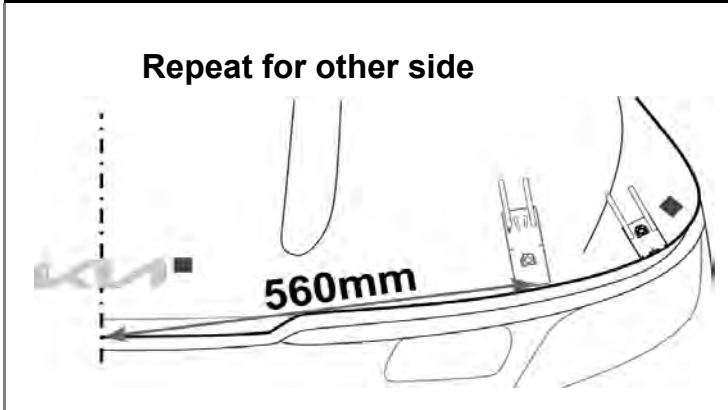

	Temporarily fit large pedestals	4
NOTE	Using the repositionable tape strips, temporarily place a mounting pedestal in the position illustrated.	

Repeat for other side

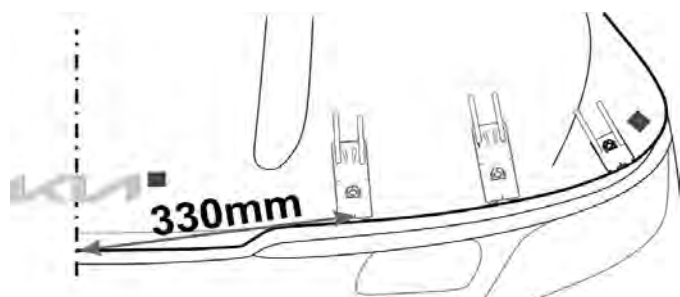

Temporarily fit large pedestals

5

NOTE

Using the repositionable tape strips, temporarily place a mounting pedestal in the position illustrated.

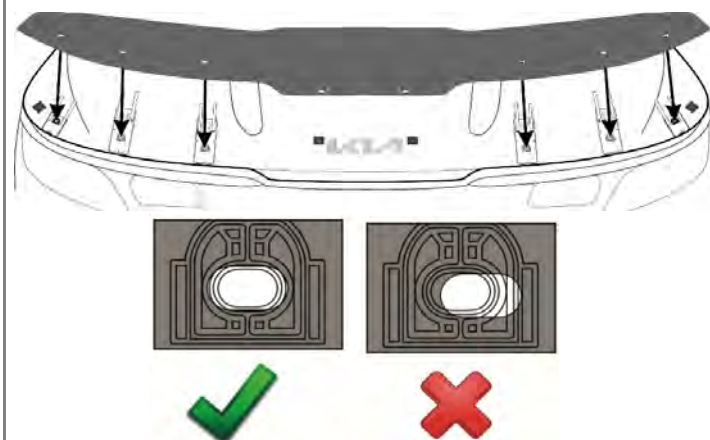

Test fit hood protector

6

NOTE

Verify the holes in the protector align with the those in the pedestals.

If necessary, reposition the pedestals so all attachment positions are correct and the protector is well centered.

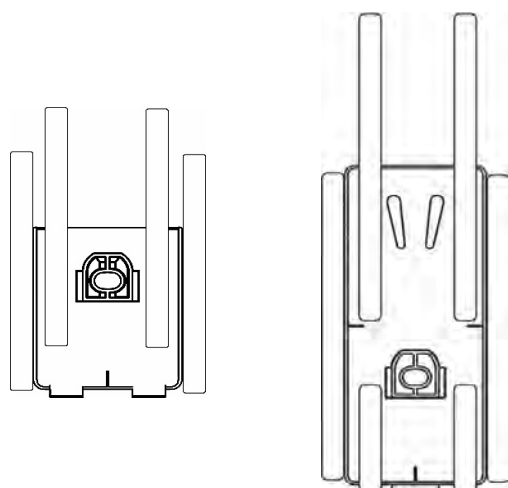

Outline pedestals

7

NOTE

Once the location of each pedestal has been established, outline its position with the supplied tape strips or masking tape.

Proper marking and prepping of all pedestal locations is critical. Accurately installing them in the exact position is very important. Once attached, the pedestals are very difficult to remove - place them correctly the first time.

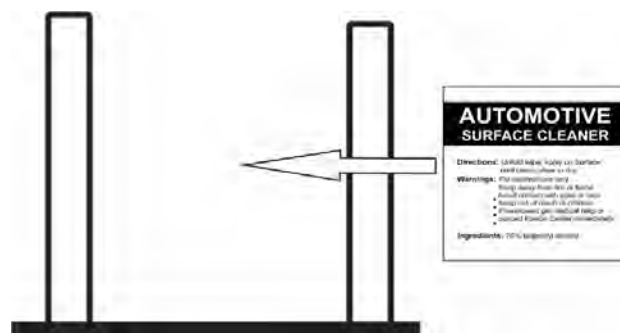

Clean the surface

8

NOTE

Remove the pedestal and thoroughly clean the outlined area with the surface cleaner. Wipe dry with a clean cloth or paper towel. This will insure all wax, finger prints and oils are removed from the hood surface in the bonding area.

Important: Proper preparation of the hood surface will ensure maximum adhesive bond.

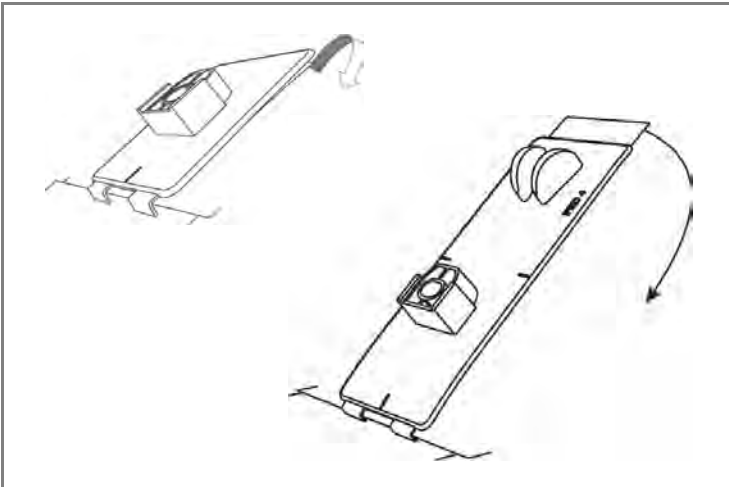

Attach pedestals

9A

NOTE

Remove the red backing from the adhesive and install on the hood surface.

Tip: Hook the fingers on the pedestal over the hood edge and rotate the unit into position. After installation, remove the tape

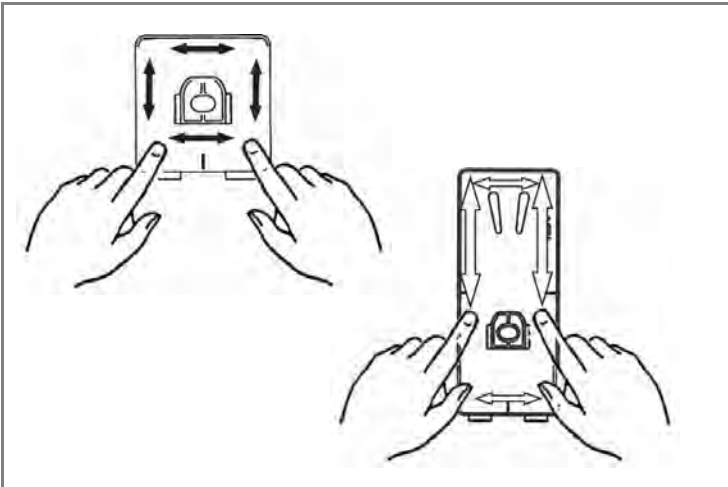

Attach pedestals

9B

NOTE

Important: “wetting out” of the pedestal will ensure maximum adhesive bond.

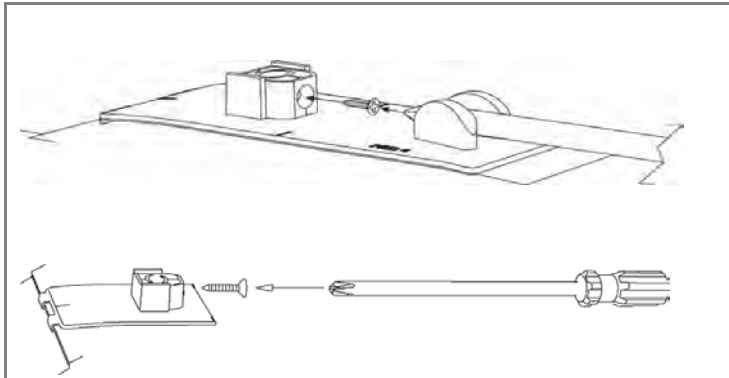

Start screws

10

NOTE

Start a screw into each pedestal a few turns. The tip of the screw must not protrude into the hole where the attachment pin will install later.

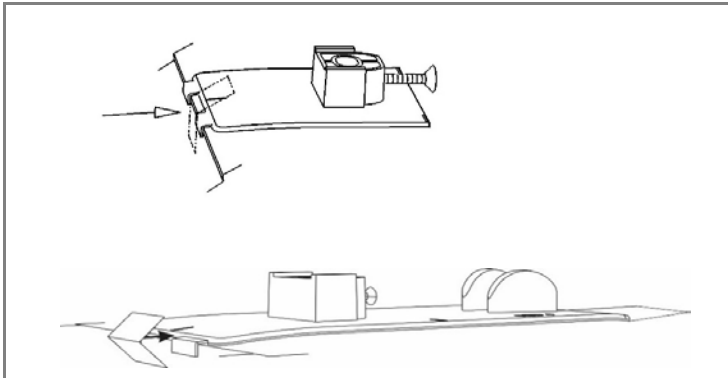

Install anti-abrasion film

11

NOTE

Peel and fold the anti-abrasion film pads in half over the hood edge between the fingers on each of the mounting

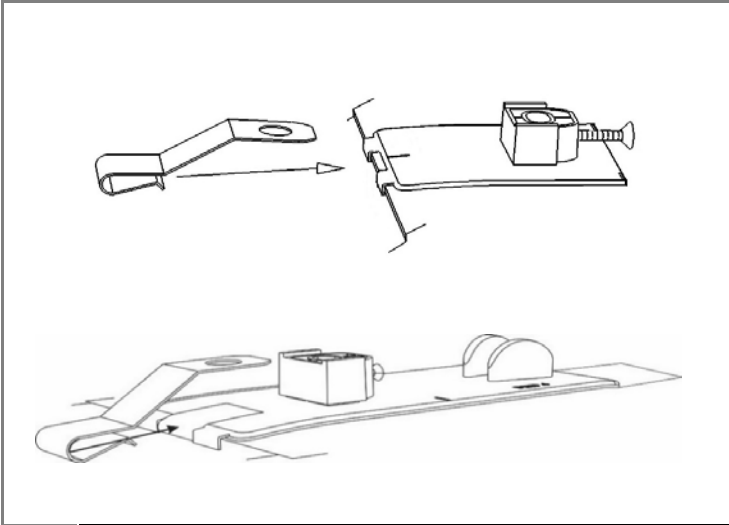

Install metal brackets		12
NOTE	Push metal mounting brackets over the hood edge aligned with the anti-abrasion pads. Ensure the bracket is fully seated over the hood edge and the hole in the bracket is aligned with the hole in the pedestal.	

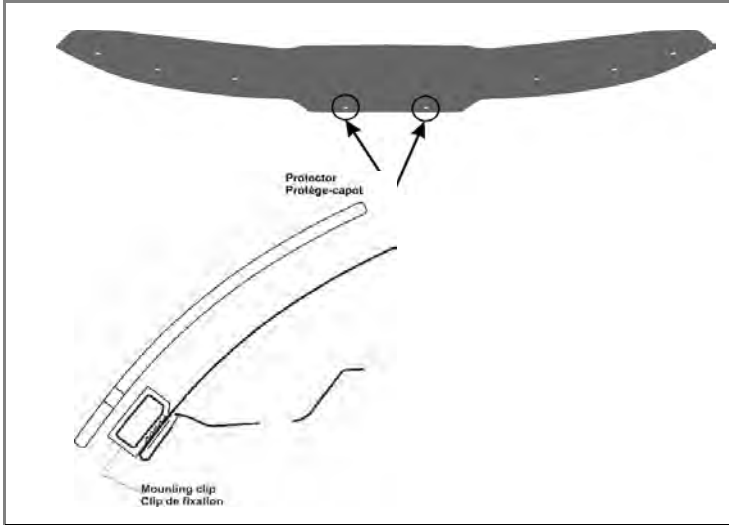

Attach mounting clips, Step 1		13
NOTE	At the centre, place a clip body over the anti-abrasion film pad on the edge of the hood.	

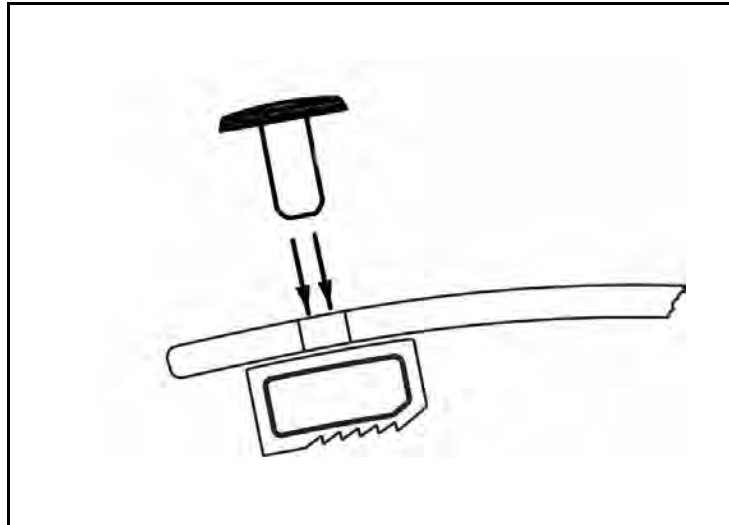

Attach mounting clips, Step 2		14
NOTE	Insert a pin through the protector into the clip body.	

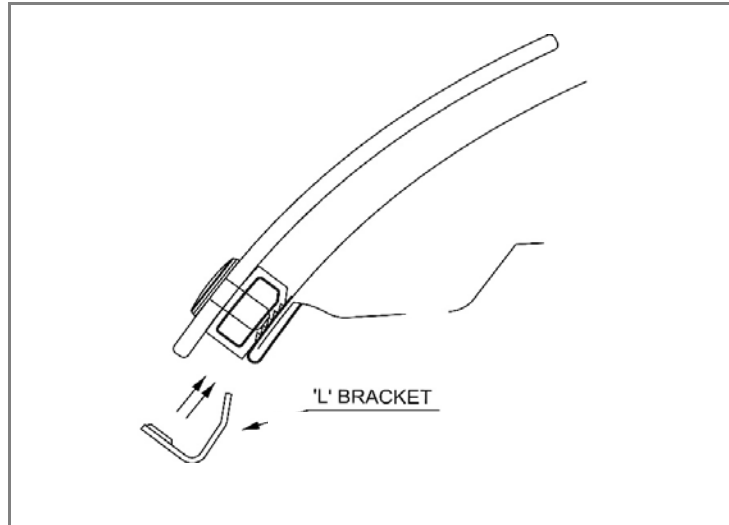

Attach mounting clips, Step 3		15
NOTE	Place an "L" bracket over the hood edge and against the clip body.	

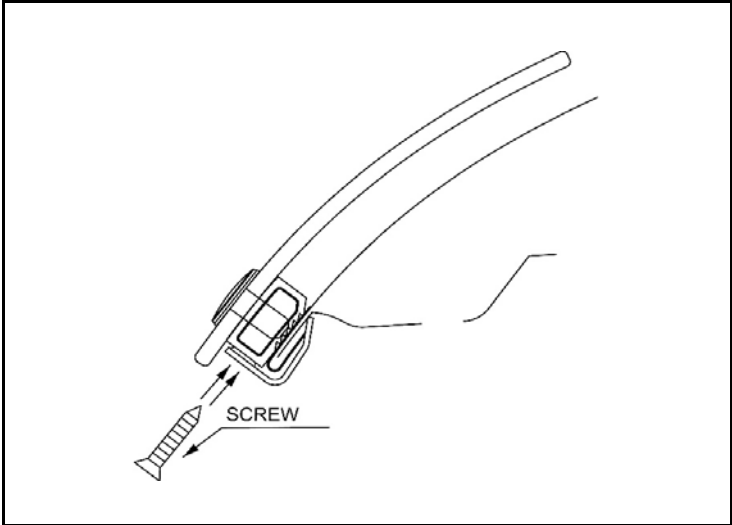

Attach mounting clips, Step 4		16A
NOTE	Insert a screw into the clip body. Maintain slight pressure on the pin to ensure proper seating of the components, while simultaneously tightening the screw.	

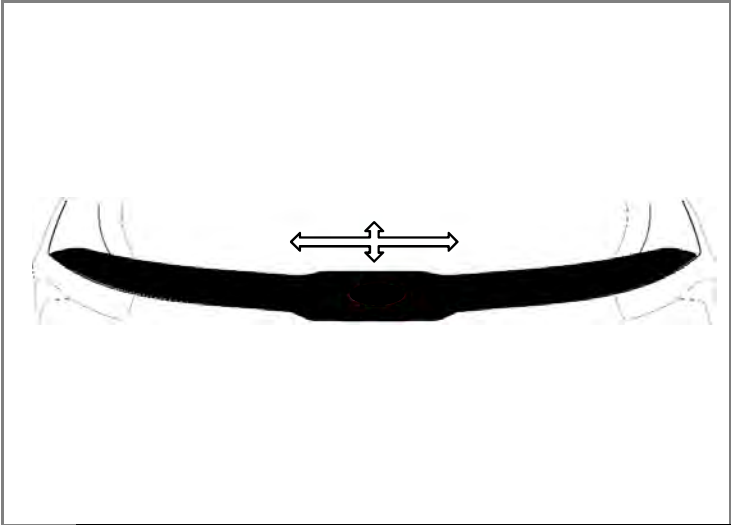

Attach mounting clips, Step 5		16B
NOTE	NOTE: Only tighten screws a few turns, so the pins are held in place, but there is still some movement of the protector. This assists in final alignment of all attachment positions.	

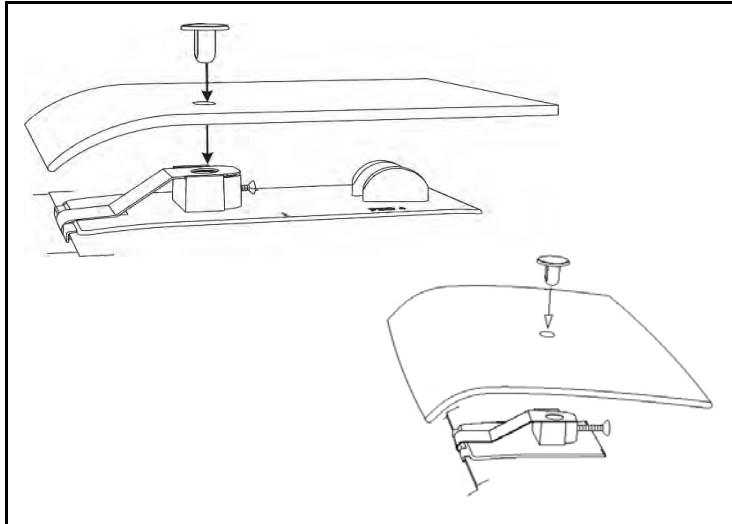

Install pins		17
NOTE	Install a pin through the protector and into the pedestals.	

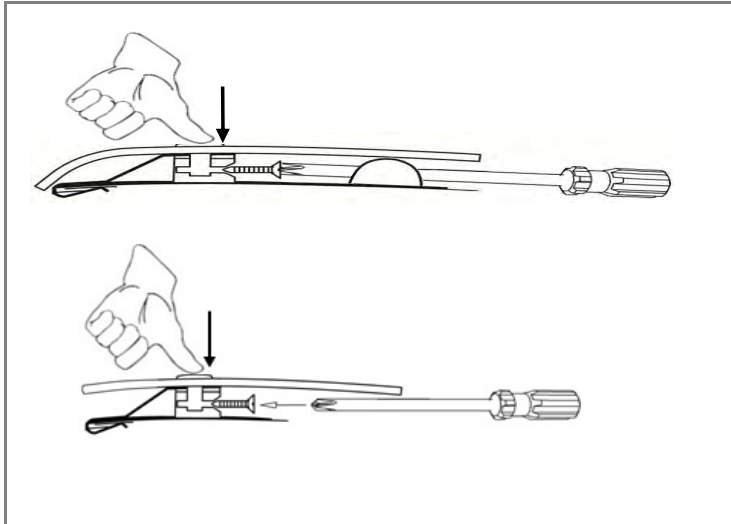

Partially tighten screws		18
NOTE	Maintain slight pressure on the pin to ensure proper seating of the components, while simultaneously tightening the screw a few turns. Repeat for remaining pedestal locations. Note: Only partially tighten the screws to make sure minor alignment to the protector is allowed.	

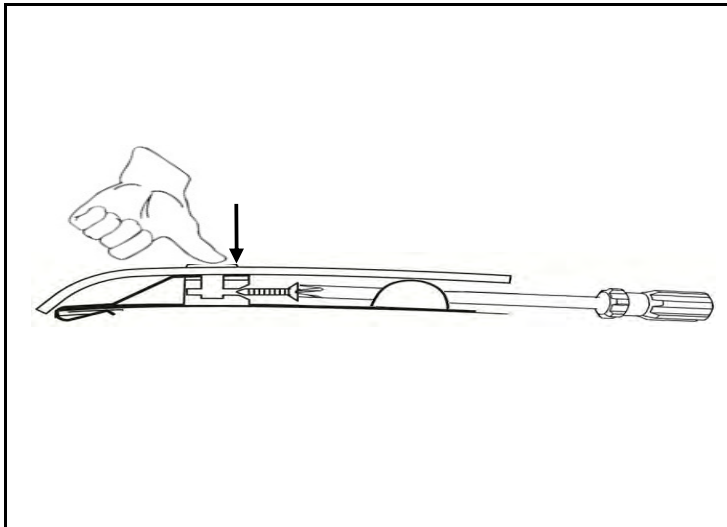

	Finish tightening the screws	19
N O T E	<p>Confirm protector is centered on hood. Starting at the center location, tighten all the screws that were loosely installed.</p> <p>Note: Do not overtighten screws.</p>	

Product Information

- Clean the protector with either a mild soap/water solution or utilize a plastic cleaner. Do not use chemicals or solvents.
- Periodically check to make sure the bumpons are in place and that the hood protector is secure.
- Avoid using automatic car washes. Do not pull on the protector when opening or closing the hood.

Thank you for purchasing a **FORMFIL** Hood Protector.

Please retain this sheet for care instructions and kit information. If you have any questions regarding our product, please contact us via email at customer@focusauto.com or visit our website at www.formfithoodprotectors.com.